

Miller

PROPERTIES & INVESTMENTS

HERITAGE MARKET I

2820 Second Street South, St. Cloud, MN

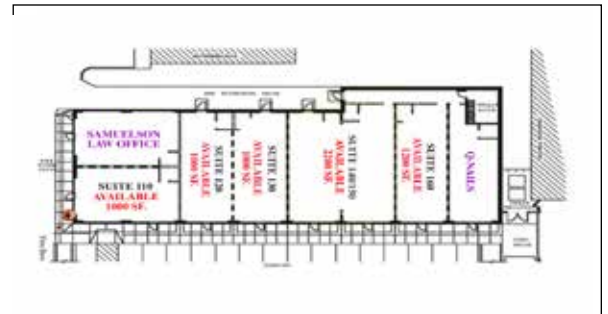

Perfectly situated on a high traffic location in St. Cloud

AVAILABLE SUITES:

- Suite 110 - 1000 sf.
- Suite 120 - 1,000 sf.
- Suite 130 - 1,000 sf.
- Suite 140/150 - 2,200 sf.
- Suite 160 - 1200 sf.

Strategically located off of 2nd Street, this property offers excellent demographics, traffic volume, ease of access and visibility. Excellent opportunity to position your office/retail business at a full access intersection. Ample parking and signage available.

- Heat and Air Conditioning Included in CAM
- 2018 Estimated CAM, \$7.03 per square foot

Miller Properties & Investments
PO Box 1228, St. Cloud, MN 56302
320.251.4109 / 800.772.1758
www.millerproperties.com

Tom Bösl
320.249.9275 cell
tomb@millerproperties.com



Bob Plombon
320.493.4325 cell
bobp@millerproperties.com

